

# zoombak™

## Dog Locator User Guide



# **Zoombak Services**

**Dog Locator**

**[www.zoombak.com](http://www.zoombak.com)**

## **COPYRIGHTS**

© 2007 Zoombak. All rights reserved.

Zoombak is a trademark of Zoombak, LLC.

## **NOTICES**

This document neither grants any license nor conveys any rights with respect to the subject matter hereof or otherwise. Zoombak expressly retains all intellectual and other property rights with respect to this document and all matters set forth herein. This document is neither an offer nor an acceptance. Neither party will be obligated with respect to the subject matter hereof unless and until such party has entered into a definitive agreement, and then only in accordance with the terms of such agreement. Some technical assertions of capability included herein are estimates based on limited information gathered from past experience.

## **TRADEMARKS**

Zoombak™ and the Zoombak logo are trademarks owned by Zoombak, LLC and protected in the United States and other countries.



# Table of Contents

Introduction .....	1
Getting Started .....	2
Key Functions .....	2
Zoombak Dog Locator Package Contents.....	3
Using the Dog Locator.....	4
Charging the Battery .....	4
Battery Life.....	5
Powering the Dog Locator ON/OFF.....	6
Monitoring the Dog Locator Status.....	6
Placing the Locator on Your Dog.....	7
Safety and Warranty Information .....	8
Safety Information .....	8
FCC Regulations.....	9
Zoombak Locator Disposal and Recycling.....	10
Reduction of Hazardous Materials (RoHS) .....	10
Specific Absorption Rate (SAR).....	10
Warranty Information.....	11
Service After Expiration of Warranty .....	11
Warranty Limitations .....	11
Water Resistance .....	11
Contacting Customer Care .....	12
Specifications and Certifications .....	13
Dog Locator Specifications .....	13
Certifications.....	14
AC Wall Charger Specifications .....	14
Important Coverage Information.....	14

# Introduction

Thank you for purchasing the Zoombak Dog Locator. Zoombak is focused on the development and marketing of breakthrough mobile communications solutions that leverage the power of wireless technology and location-based services to provide people with new ways to connect to each other and their world.

This Guide will introduce you to all of the features of your Zoombak Dog Locator device. If you have any questions, please contact Zoombak Customer Care at 1-866-951-0101 or visit our website at [www.zoombak.com](http://www.zoombak.com).

Puede encontrar una versión en español de esta guía en: [www.zoombak.com/spanish](http://www.zoombak.com/spanish).

In addition to this Zoombak Dog Locator User Guide, included in your package is a Zoombak Dog Locator Quick Start Guide. The Quick Start Guide will briefly walk you through activating your service, using your service, and setting up your safety zones and alerts. For more detailed instructions on using your service, please visit [www.zoombak.com](http://www.zoombak.com).

Please read this Zoombak Dog Locator User Guide and the accompanying Quick Start Guide before setting up your account prior to use. Activation and use of the Zoombak Locator are subject to Zoombak's customer agreement, plans, terms and conditions, which can be found at [www.zoombak.com/terms](http://www.zoombak.com/terms).

The Zoombak Dog Locator User Guide is divided into five main sections:

- Section 1. Getting Started
- Section 2. Using the Dog Locator
- Section 3. Safety and Warranty Information
- Section 4. Contacting Customer Care
- Section 5. Specifications and Certifications

## Getting Started

This section addresses two primary areas:

- Zoombak Dog Locator Features
- Zoombak Dog Locator Package Contents

### Front/Aerial View of Locator

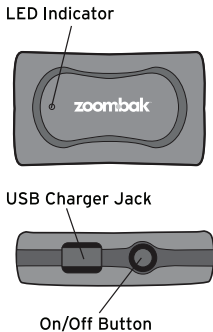

### Key Functions

- USB Charger Jack—Connects the Zoombak Dog Locator to the AC Wall Charger (included)
- Locator Status LED Indicator—Allows you to monitor (at a glance) the power and battery status of your Zoombak Dog Locator

## Zoombak Dog Locator Package Contents

When you purchase the Zoombak Dog Locator, the package should contain the following:

- Zoombak Dog Locator
- Zoombak Dog Locator Pouch (to attach the Locator to your dog's collar)
- AC Wall Charger
- Zoombak Dog Locator Quick Start Guide
- Zoombak Dog Locator User Guide



Zoombak Dog Locator

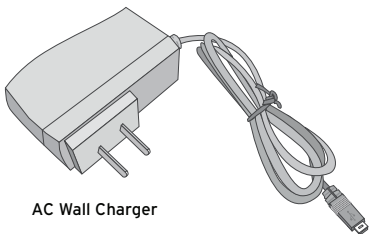

AC Wall Charger

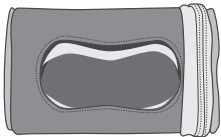

Zoombak Dog Locator Pouch

If any of these items are missing from your package, please contact Zoombak Customer Care at 1-866-951-0101.

## Using the Dog Locator

This section addresses five primary areas:

- Charging the Battery
- Battery Life
- Powering the Dog Locator ON/OFF
- Monitoring the Dog Locator Status
- Placing the Locator on Your Dog

### Charging the Battery

**Before** using the Zoombak Dog Locator for the first time, you will need to fully charge the battery. Follow these simple instructions to charge the battery. The initial battery charge time will be 6 hours; each subsequent battery charge will be approximately 4 hours.

1. Remove the Zoombak Dog Locator and AC Wall Charger from the Zoombak Dog Locator package.
2. Plug the AC Wall Charger into a wall outlet.
3. Attach the Zoombak Dog Locator to the AC Wall Charger via the USB Charger Jack on the Zoombak Dog Locator.

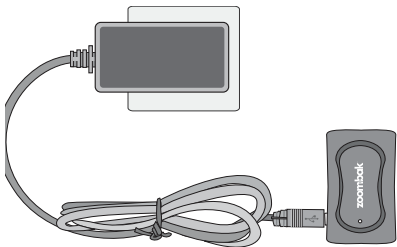

4. The Locator Status LED Indicator will glow amber (yellow), indicating that the Zoombak Dog Locator is charging.
5. Once the Locator Status LED Indicator glows green, this will signal that the Zoombak Dog Locator is fully charged.

## Battery Life

Mode	Battery Life
Standby	Up to 120 hours or 5 days
Active Locator Service	Up to 150 Location Requests

Battery life depends on several factors including temperature, network, signal strength and Locator service features used. Location requests include the following Zoombak Locator service features: "Find Now," "Safety Zones" mode and "Continuous Tracking" mode. When your Zoombak Locator indicates low battery (blinking amber LED), recharge your battery as defined in the section of this User Guide titled "Charging the Battery."

Rechargeable batteries have a limited number of charge cycles and may eventually need to be replaced. The Zoombak Locator battery is not user replaceable; it can only be replaced by an authorized service provider. For more information, go to: [www.zoombak.com](http://www.zoombak.com).

## Powering the Dog Locator ON/OFF

In order to power the Zoombak Dog Locator on or off, follow these simple instructions:

1. **Power ON**—Press and hold the Power Button until the Locator Status LED Indicator begins to glow (approximately two seconds). Blinking green indicates operation OK.
2. **Power OFF**—Press and hold the Power Button until the Locator Status LED Indicator begins to flash quickly (approximately two seconds). Locator Status LED Indicator will shut OFF when the Locator has properly shut down. A key feature of your Zoombak Dog Locator during the power off process is that the Locator will determine its current location and send a power off notification via email and/or mobile text message with its current location and time/date information (see the Zoombak Dog Locator Quick Start Guide for details on setting up your alerts). The Locator Status LED Indicator will continue to blink during the power off process, which may take up to 2 minutes to complete this important notification feature.

## Monitoring the Dog Locator Status

Refer to the following list in order to determine the status of your Zoombak Dog Locator LED Indicator at any time.

BLINKING GREEN	Indicates Power ON
BLINKING AMBER (YELLOW-ORANGE)	Indicates Low Battery
GREEN	Indicates Fully Charged (When Charging)
AMBER (YELLOW-ORANGE)	Indicates Charging
NO COLOR	Indicates Power OFF or Battery Needs to Be Charged

## Placing the Locator on Your Dog

In order for the Zoombak Dog Locator to help locate your dog, the Locator must be attached to your dog's collar. **The Zoombak Dog Locator is not recommended for dogs under 15 lbs.** Follow these simple instructions to attach the Zoombak Dog Locator to your dog's collar:

1. Place the Zoombak Dog Locator in the Zoombak Dog Pouch, as shown.

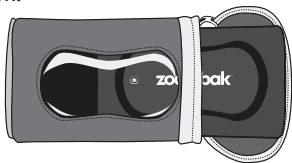

2. Once the Zoombak Dog Locator is in the pouch, place the Zoombak Dog Locator Pouch on your dog's collar, as indicated below. Please note that the pouch will attach to any type, form or size collar.

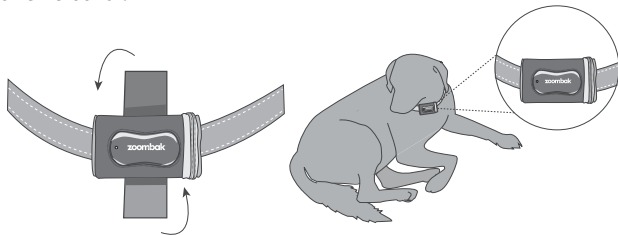

3. To detach the Locator from your dog, simply remove the Zoombak Dog Locator from the pouch using the zipper, without removing the entire pouch from your dog's collar.
4. If your dog scratches at the Zoombak Dog Locator, allow him/her time to get accustomed to wearing it. There may be an adjustment period.

## Safety and Warranty Information

This section addresses six primary areas:

- Safety Information
- FCC Regulations
- Reduction of Hazardous Materials (RoHS)
- Specific Absorption Rate (SAR)
- Warranty Information
- Water Resistance

### Safety Information

Your Zoombak Dog Locator contains a Lithium Ion (LI) battery pack. Leakage of ingredients contained within the battery pack or the combustion of ingredients can cause personal injury to you or your dog as well as damage to your Zoombak Dog Locator. If battery leakage occurs, avoid contact with skin. If contact occurs, immediately wash thoroughly with soap and water. If liquid leaking from battery pack comes in contact with your eyes, immediately flush your eyes thoroughly with water and contact your doctor. In case of ingestion, immediately contact your doctor and/or go to the emergency room.

If the battery leaks into your dog's fur, immediately wash the affected area with soap and water and wrap the area to prevent the dog from licking the leakage from their fur. If liquid leaking from the battery pack comes in contact with your dog's eyes, immediately flush them with water and contact your veterinarian. If your dog ingests battery fluid, DO NOT induce vomiting (as this can further damage your dog's GI tract). Should ingestion occur, immediately contact your veterinarian or ASPCA Animal Poison Control Center at 1-888-426-4435. Please note that there is a \$55 consultation fee associated with contacting the ASPCA.

To avoid battery leakage:

- Do not expose battery to excessive vibration, physical shock or liquids.
- Do not disassemble, attempt to repair or deform the battery.
- Do not dispose of battery pack in fire.
- Do not peel or damage the battery label.

## **FCC Regulations**

This Locator complies with part 15 of the FCC Rules. Operation is subject to the following two conditions: (1) This Locator may not cause harmful interference, and (2) this Locator must accept any interference received, including interference that may cause undesired operation.

This Locator has been tested and found to comply with the limits for a Class B digital Locator, pursuant to Part 15 of the FCC Rules. These limits are designed to provide reasonable protection against harmful interference in a residential installation. This equipment generates, uses and can radiate radio frequency energy and, if not installed and used in accordance with the instructions, may cause harmful interference to radio communications. However, there is no guarantee that interference will not occur in a particular installation.

If this equipment does cause harmful interference to radio or television reception, which can be determined by turning the equipment off and on, the user is encouraged to try to correct the interference by one or more of the following measures:

- Reorient or relocate the receiving antenna.
- Increase the separation between the equipment and receiver.
- Connect the equipment into an outlet on a circuit different from that to which the receiver is connected.
- Consult the dealer or an experienced radio/TV technician for help.
- Changes or modifications not expressly approved by the party responsible for compliance could void the user's authority to operate the equipment.

## **Zoombak Locator Disposal and Recycling**

### **CAUTION:**

**RISK OF EXPLOSION IF BATTERY IS REPLACED BY AN INCORRECT TYPE. DISPOSE OF USED BATTERIES ACCORDING TO THE INSTRUCTIONS.**

You must dispose of the Zoombak Locator properly according to local laws and regulations. Because the Zoombak Locator contains electronic components and a battery, the Zoombak Locator must be disposed of separately from household waste. When the Zoombak Locator reaches its end of life, contact local authorities to learn about disposal and recycling options. See [www.zoombak.com](http://www.zoombak.com) for more information.

## **Reduction of Hazardous Materials (RoHS)**

This Locator does not contain lead, cadmium, mercury, hexavalent chromium, polybrominated biphenyl (PBB) or polybrominated diphenyl ether (PBDE).

## **Specific Absorption Rate (SAR)**

Your Zoombak Dog Locator is a radio transmitter and receiver. It does not exceed exposure limits set by the Federal Communications Commission (FCC) and international guidelines established by the independent scientific organization ICNIRP.

The exposure standard for wireless devices uses a unit of measure called Specific Absorption Rate (SAR). The SAR limit set by the FCC is 1.6 W/kg. The SAR limit set by ICNIRP is 2.0 W/kg averaged over 10 grams of tissue. Tests for SAR are conducted at standard operating positions with the Locator transmitting at its highest power level over all frequency bands. The actual SAR level of an operating Locator can be below the maximum value because the Locator is designed to only use the power level required to reach the network.

## Warranty Information

Zoombak, LLC warrants to the original purchaser that the Locator shall be free from defects in material and workmanship for a period of 12 months from date of activation. If a defect covered by this warranty occurs during the warranty period, Zoombak will repair or replace your Locator product or component free of charge. If your Locator is replaced for a defect covered under warranty, you may receive a refurbished Locator in exchange for your original Locator. The replaced unit will carry the remaining warranty period from the original Locator.

## Service After Expiration of Warranty

Please visit our website at [www.zoombak.com](http://www.zoombak.com) or call our Customer Care Center at 1-866-951-0101 for troubleshooting information and repair or replacement options. In most cases, it will be necessary to ship the product to Zoombak. Please do not send any products to Zoombak without first contacting our Customer Care Center.

## Warranty Limitations

THIS WARRANTY SHALL BE NULL AND VOID IF THIS PRODUCT:  
(a) IS USED FOR COMMERCIAL PURPOSES; (b) IS MODIFIED, OPENED OR TAMPERED WITH; (c) IS DAMAGED BY NEGLIGENCE, ACCIDENT, UNREASONABLE USE OR OTHER CAUSES UNRELATED TO DEFECT IN MATERIAL OR WORKMANSHIP.

## Water Resistance

The Zoombak Dog Locator has a water resistance rating of IPX6. The Locator will continue to function when subjected to splashes of water. This Locator is not waterproof and will not function when submerged in water. **DO NOT allow your dog to swim with the Zoombak Dog Locator.**

## **Contacting Customer Care**

Need help with operating your Zoombak Dog Locator? Contact Zoombak Customer Care via the internet at [www.zoombak.com](http://www.zoombak.com) or call toll free 1-866-951-0101, Monday - Sunday, 24 hours a day (times subject to change) to speak to a Customer Care representative.

## Specifications and Certifications

This section provides the following detailed Specifications and Certifications:

- Dog Locator Specifications
- Certifications
- AC Wall Charger Specifications

### Dog Locator Specifications

Feature	Specification								
Size	72.9 x 43.1 x (19.07 ~ 20.07) mm								
Weight	2.5 ounces								
Frequency	<table border="1"><thead><tr><th>Model Number ZB100</th><th>Model Number ZB101</th></tr></thead><tbody><tr><td>GSM 850 = ZB-100 824 - 849 MHz (Tx) 925 - 960 MHz (Rx)</td><td>GSM 900 = ZB-101 880 - 915 MHz (Tx) 869 - 894 MHz (Rx)</td></tr><tr><td>GSM 1800 1710 - 1785 MHz (Tx) 1805 - 1865 MHz (Rx)</td><td>GSM 1800 1710 - 1785 MHz (Tx) 1805 - 1865 MHz (Rx)</td></tr><tr><td>GSM 1900 1850 - 1910 MHz (Tx) 1930 - 1990 MHz (Rx)</td><td>GSM 1900 1850 - 1910 MHz (Tx) 1930 - 1990 MHz (Rx)</td></tr></tbody></table>	Model Number ZB100	Model Number ZB101	GSM 850 = ZB-100 824 - 849 MHz (Tx) 925 - 960 MHz (Rx)	GSM 900 = ZB-101 880 - 915 MHz (Tx) 869 - 894 MHz (Rx)	GSM 1800 1710 - 1785 MHz (Tx) 1805 - 1865 MHz (Rx)	GSM 1800 1710 - 1785 MHz (Tx) 1805 - 1865 MHz (Rx)	GSM 1900 1850 - 1910 MHz (Tx) 1930 - 1990 MHz (Rx)	GSM 1900 1850 - 1910 MHz (Tx) 1930 - 1990 MHz (Rx)
Model Number ZB100	Model Number ZB101								
GSM 850 = ZB-100 824 - 849 MHz (Tx) 925 - 960 MHz (Rx)	GSM 900 = ZB-101 880 - 915 MHz (Tx) 869 - 894 MHz (Rx)								
GSM 1800 1710 - 1785 MHz (Tx) 1805 - 1865 MHz (Rx)	GSM 1800 1710 - 1785 MHz (Tx) 1805 - 1865 MHz (Rx)								
GSM 1900 1850 - 1910 MHz (Tx) 1930 - 1990 MHz (Rx)	GSM 1900 1850 - 1910 MHz (Tx) 1930 - 1990 MHz (Rx)								
Transmit Power	Up to 2W								
Battery Voltage	3.7 v								
Operating Temp.	-20° C to +60° C								
Water Resistance	IPX6								

## Certifications

CE	FCC: U2I-ZB100
IC: 6950A-ZB100	PTCRB
CTIA	ETSI
GCF	UL, UK (battery and charger)

## AC Wall Charger Specifications

Input: 90 - 264 VAC, 47 - 63 Hz
Output: 5.4 VDC @ 1.2A, short-circuit protected
Operating Temperature: -5° C to +45° C

## Important Coverage Information

Our coverage maps provide high-level estimates of our coverage areas when using your device outdoors under optimal conditions. Coverage isn't available everywhere. Estimating wireless coverage and signal strength is not an exact science.

There are gaps in coverage within our estimated coverage areas that, along with other factors (network problems, software, signal strength, your wireless device, structures, buildings, weather, geography, topography, etc.), will result in dropped and blocked connections, slower data speeds, or otherwise impact the quality of services.

Services that rely on location information depend on your device's ability to acquire satellite signals (often not available indoors) and network coverage. Estimated future coverage subject to change. See [www.zoombak.com](http://www.zoombak.com) for coverage map and details.